

The Sensory Nest

Brief:

The Sensory Nest is a specialized intervention designed to support autistic children aged 11–16 through sensory-sensitive architecture. This therapeutic hub aims to provide comfort, safety, and stimulation in equal measure, acting as a bridge between traditional school environments and the individual needs of neurodiverse users.

The concept centers around the idea of a “nest” – a safe, nurturing, and adaptable space. The design integrates sensory zoning, flexible layouts, and natural materials and biophilic design elements to reduce anxiety, promote independence, and encourage exploration.

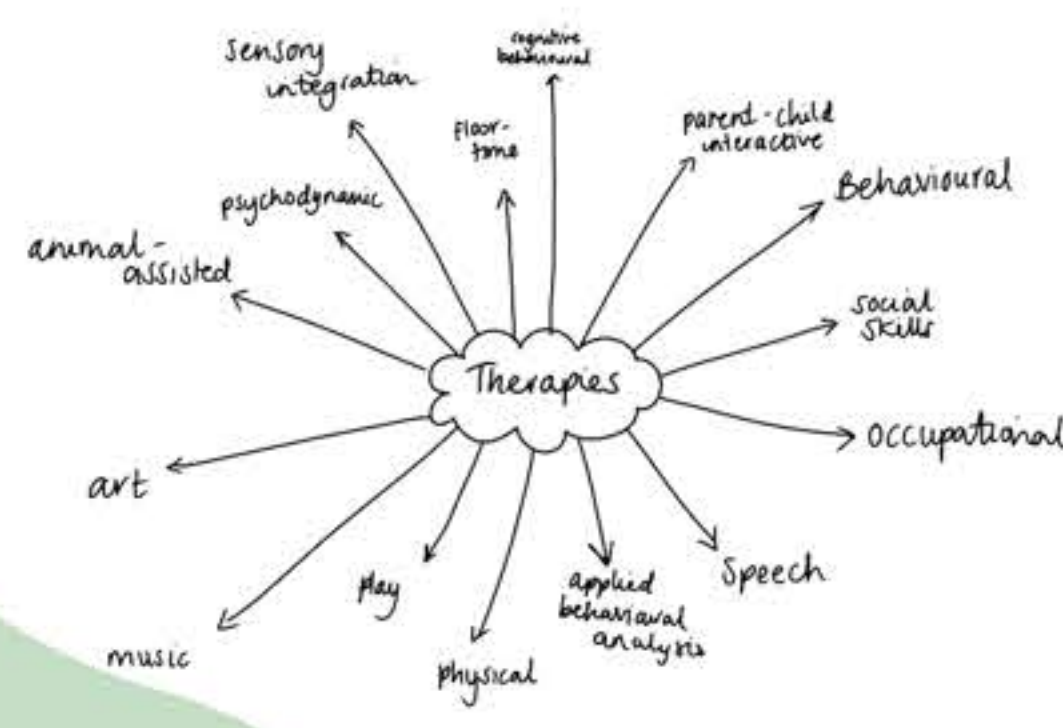

Site Address:

Gisborough Hall
Whitby Road
Guisborough
TS14 6PT

Key Positives:

- > Easily Accessible
- > Onsite carparking
- > Proximity to local schools
- > Rural
- > Biophilic environment



The location of the intervention has been carefully selected to provide close proximity to the local town, whilst also providing a private, quiet setting away from overstimulating environments.



Symptoms of children having Autism

Strengths Associated with Autism



Hyper- or hyporeactivity to sensory input



Analytical/ Problem Solving



Social and communication deficits (verbal and non-verbal)



Creativity and Imagination



Attachment to sameness, routine and behaviour



Visual Skills



Difficulties in relationship development, maintenance and understanding



Observational Skills



Materiality

Colour theories are an important factor of the design, both in incorporating biophilic design and to enable autistic users, by creating a space that reduces overstimulation and feels calm.

Natural, muted tones have shown promise in creating this hence the choice of colour palette:

- > pastel greens
- > pastel blues
- > earthy tones
- > white (and offwhite tones)



Users

Primary Users - Autistic Children ages 11–16

Secondary Users - Parents and carers of the children
- Therapists and Staff Members

Biophilic Principles

- > Natural lighting
- > Material Selection
- > Natural Curves
- > Colour Palette

Material Selection

By choosing natural materials, consistently using oak wooden textures for the flooring and parametric seating there is a flow through the building which

- > provides a tactile surface
- > connects the interior to the exterior
- > guides visitors through the building
- > is visually effective as there are fewer barriers from material changes.

Natural Curves

Using natural forms and curves with the design of the bespoke parametric seating both nods toward biophilic design integrating nature in the building, while also helping to optimise acoustics by helping to control direction of soundwaves.

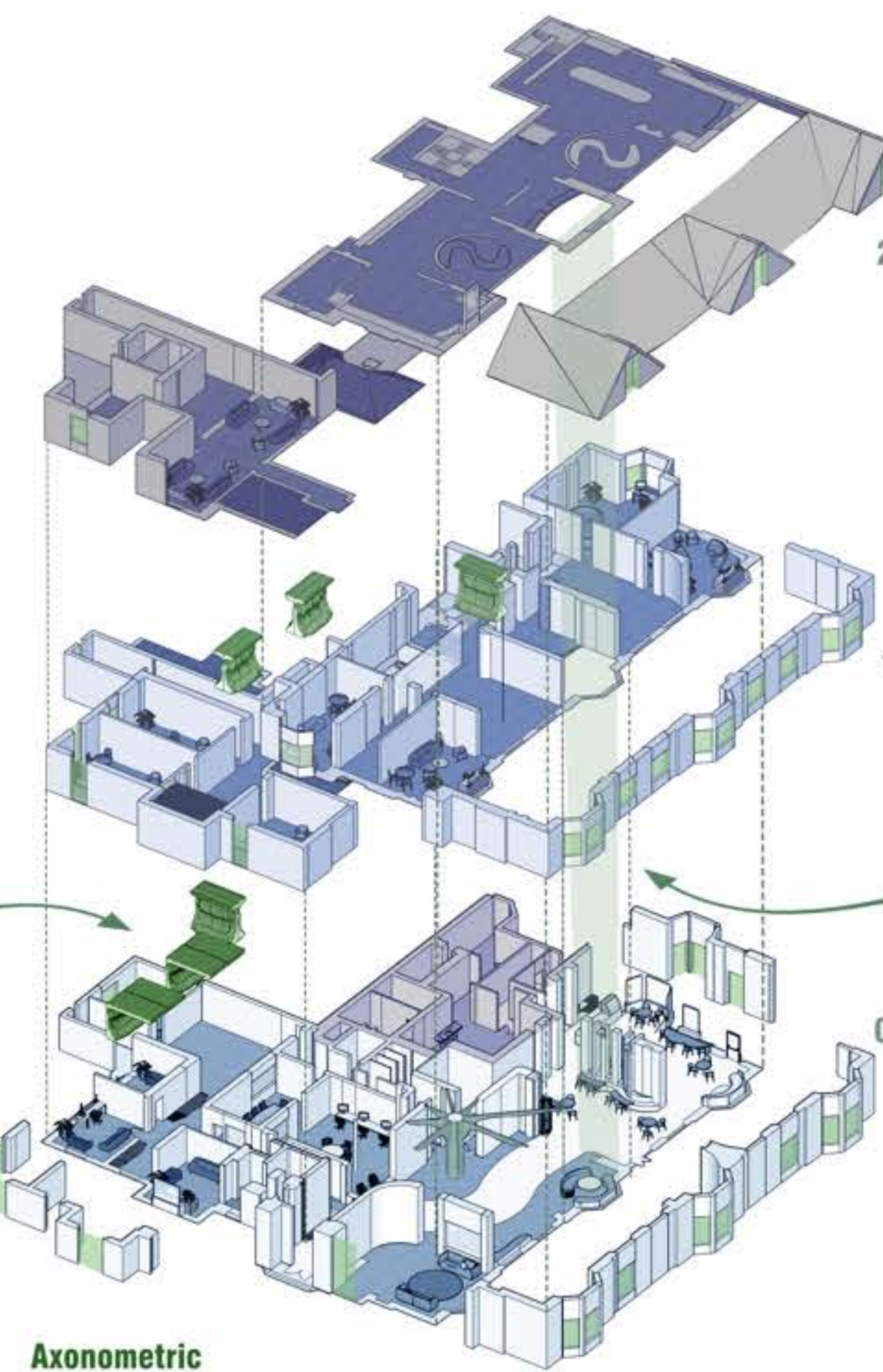

Axonometric

Building Layout

Creating a safe, considered layout by ensuring there are clearly defined public, semi-private and private spaces

Public - Located only on the ground floor and directly accessible from the entrance. 0

Semi-private - All of the therapy rooms are semi-private as access is controlled by staff at reception. The family therapy rooms and first floor are semi private. 0/1

Private - The second floor is completely separate for staff only, both for office spaces and for private staff areas for down-time. 0/2

Natural Lighting

Natural lighting can be more beneficial for autistic children and reduces the need for too much harsh artificial lighting. All artificial lighting in the building aims to be indirect and uses LEDs that offer the option to dim the lighting.

The void through from the ground to the second floor has been created to allow more natural light to flow through the

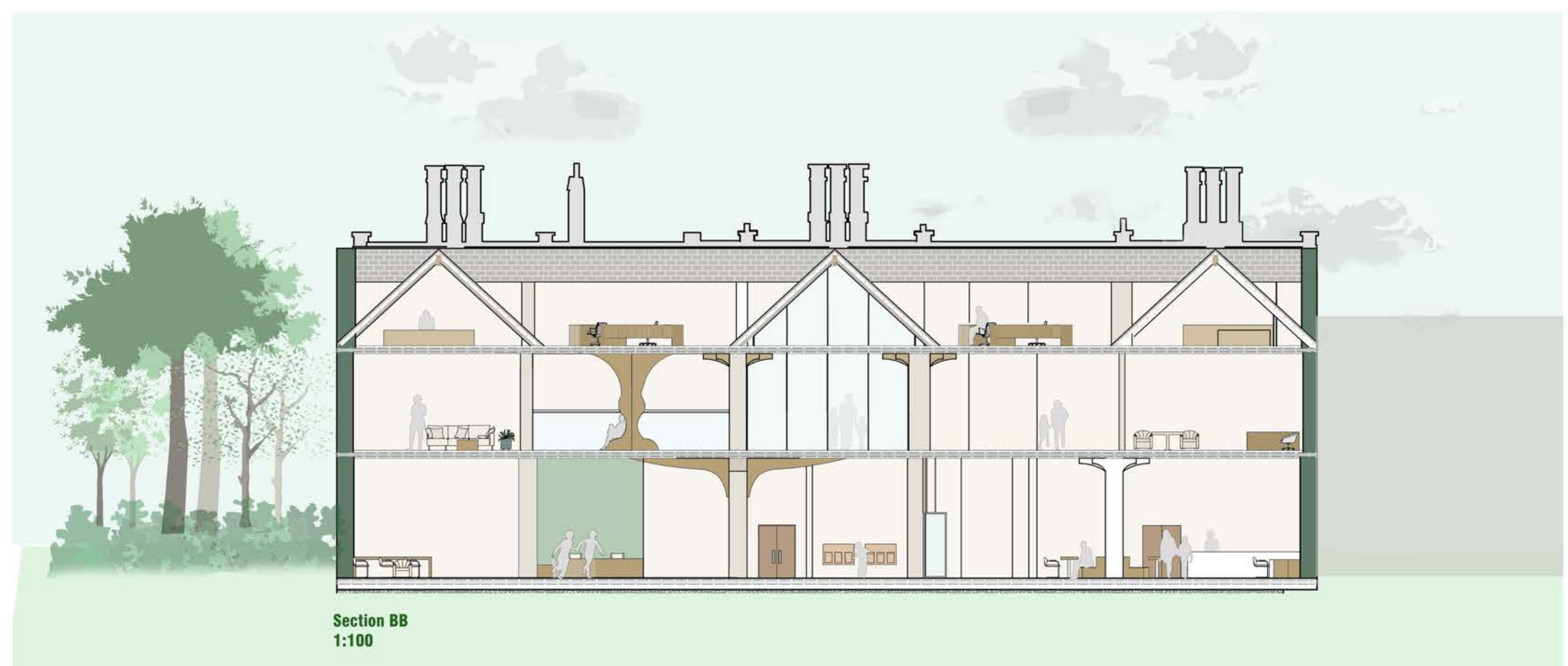

Section BB
1:100

